

# Modular Jack - .453" Height Ultra Low Profile

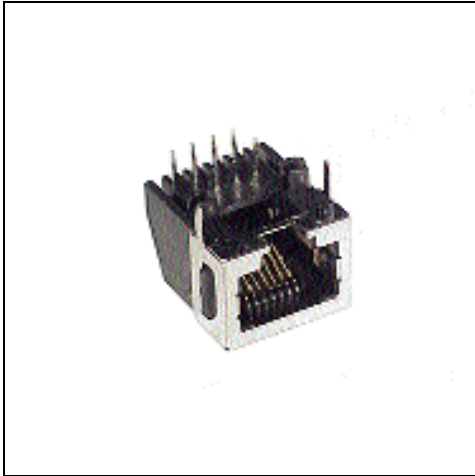

## 153-[\*]-[\*\*]

- \*Number of contacts;  
**4** = 6P4C (6 positions, 4 contacts)  
**6** = 6P6C (6 positions, 6 contacts)  
**8** = 8P8C (8 positions, 8 contacts)  
**10** = 10P10C (10 positions, 10 contacts)

- \*\*Type; **S** = Shielded    **Blank** = Unshielded  
**N** = Unshielded without panel stops



### FEATURES:

- Only .453" high, lowest height offered in this style
- Mates with Regal #1001 series

### ELECTRICAL:

- Current rating: 1 AMP maximum
- Contact resistance: 15 milliohms maximum
- Insulation resistance: 1000 Megohms minimum
- Dielectric withstanding voltage: 500 VAC

### MATERIAL:

- Insulator: UL94V-0 / PBT glass filled
- Color: Black
- Contacts: Phosphor bronze
- Plating: 6µ" gold over nickel
- Operating temperature: -55°C to 105°C

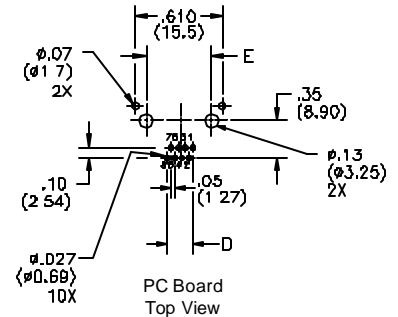
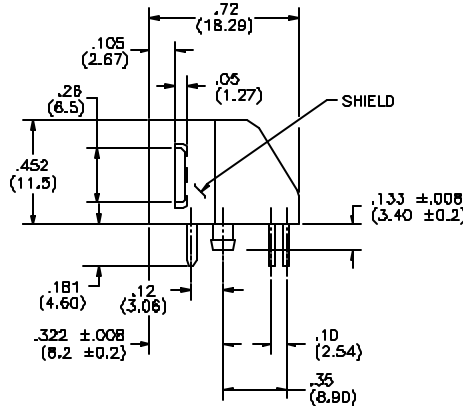
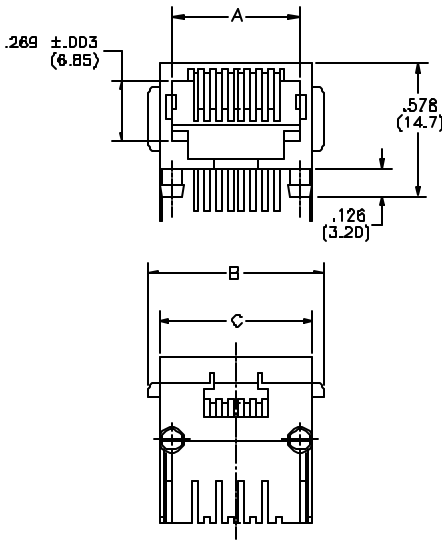

Part Number	A	B	C	D	E
153-4	.390±.004 (9.90±0.1)	.620±.004 (15.75±0.1)	.525±.004 (13.36±0.1)	.15 (3.8)	.40 (10.16)
153-4S	.390±.004 (9.90±0.1)	.620±.004 (15.75±0.1)	.545±.004 (13.84±0.1)	.15 (3.8)	.40 (10.16)
153-6	.390±.004 (9.90±0.1)	.620±.004 (15.75±0.1)	.525±.004 (13.36±0.1)	.25 (6.35)	.40 (10.16)
153-6S	.390±.004 (9.90±0.1)	.620±.004 (15.75±0.1)	.545±.004 (13.84±0.1)	.25 (6.35)	.40 (10.16)
153-8	.47±.004 (11.90±0.1)	.700±.004 (17.78±0.1)	.605±.004 (15.37±0.1)	.35 (8.89)	.45 (11.43)
153-8S	.47±.004 (11.90±0.1)	.700±.004 (17.78±0.1)	.625±.004 (15.88±0.1)	.35 (8.89)	.45 (11.43)
153-10	.47±.004 (11.90±0.1)	.700±.004 (17.78±0.1)	.605±.004 (15.37±0.1)	.45 (11.43)	.45 (11.43)
153-10S	.47±.004 (11.90±0.1)	.700±.004 (17.78±0.1)	.625±.004 (15.88±0.1)	.45 (11.43)	.45 (11.43)