

D-Subminiature Filtered Connectors

RoHS Compliant

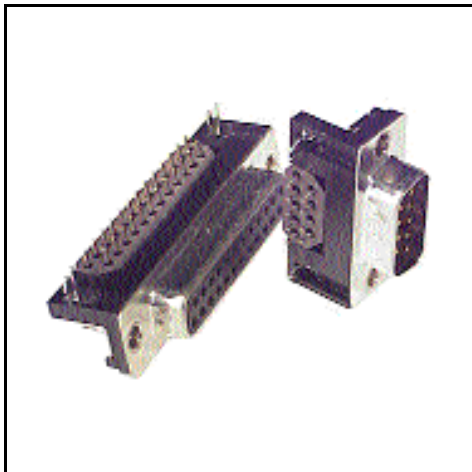

R4400-[*][]**
 .318" Standard density

R4401-15[]**
 .350" High density

*Number of contacts; Options are:
9, 15, 25

**Gender; Options are:
M = Male
F = Female

ELECTRICAL:

- Current rating: 5 AMP maximum
- Contact resistance: 15 milliohms maximum
- Insulation resistance: 1000 Megohms minimum
- Dielectric withstanding voltage: 1000 VAC

MATERIAL:

- Shell : Steel, tin plated
- Insulator: UL94V-0 / PBT glass filled
- Color: black
- Contact material: Pin = Brass,
 Socket = Phosphor bronze
- Plating: 6μ" gold flash
- Temperature: -55°C to +105°C

FEATURES:

- High-performance ferrite material with superior frequency characteristics
- Noise attenuation in signal line of data communication terminals and digital devices
- Has minimal effect on transition waveforms
- Saves energy by integrating the filter element on the data line
- More cost effective than multiple bead core packaging
- Meets shielding requirements for FCC, VDE and VCCI specifications

R4400 Series

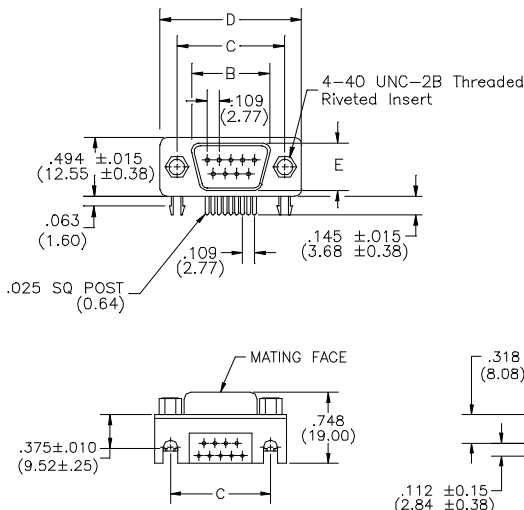

| DIMENSION CHART | | |
|-----------------|-------------------|-------------------|
| MODEL | C ± .015(0.38) | D ± .015(0.38) |
| 4400-09F | .984 | 1.216 |
| 4400-09M | (24.99) | (30.89) |
| 4400-15F | 1.312 | 1.539 |
| 4400-15M | (33.32) | (39.10) |
| 4400-25F | 1.852 | 2.090 |
| 4400-25M | (47.04) | (53.09) |

| | B ± .010(0.25) | E ± .010(0.25) |
|--------|-------------------|-------------------|
| MALE | .665 (16.90) | .329 (8.29) |
| FEMALE | .642 (16.30) | .311 (7.90) |

IMPEDANCE CHARACTERISTICS
 SINGLE TURN (INSIDE HOLE)

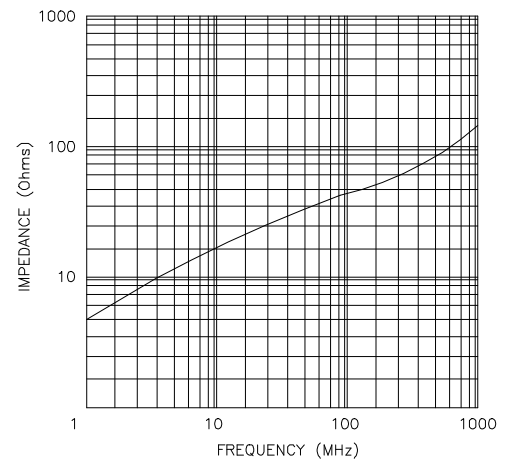

R4401 Series

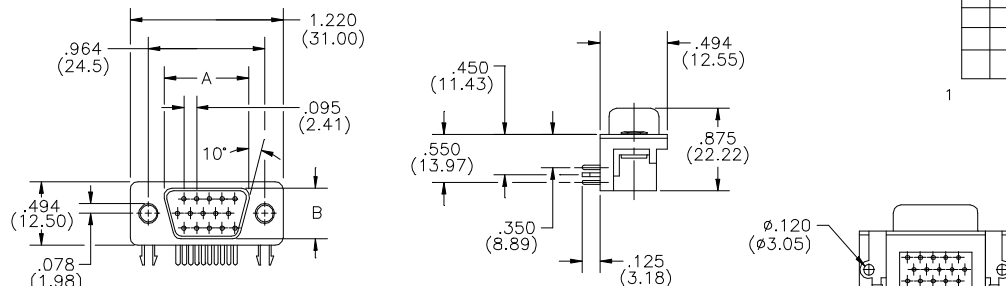

| DIMENSION CHART | | |
|-----------------|-------------------|-------------------|
| MODEL | A ± .010(0.25) | B ± .010(0.25) |
| 4401-15F | .642 (16.30) | .311 (7.90) |
| 4401-15M | .665 (16.90) | .327 (8.30) |

080520

120 San LuCar Court ▼ Sunnyvale, CA 94086 ▼ Phone 800/882-8086 ▼ Fax 800/345-2831

Visit www.regalusa.com ▼ E-mail hal@regalusa.com