



R90S-B-S

PCB female receptacle straight vertical mount

Universal Serial Bus Type B

FEATURES:

- Short body design saves PCB real estate
- Staked housing provides excellent solder tail alignment facilitating PCB mounting
- Housing stand offs for anti solder bridging
- Kinked boardlocks provide secure PCB retention
- Housing available in black or white

ELECTRICAL:

- Current rating: 1.0 Amp Max.
- Contact resistance: 30 MilliOhms MAX at 1 Amp
- Insulation resistance: 1000 MegOhms at 500V DC
- Operating temperature: -55°C to +85°C
- Dielectric withstanding voltage: 750 VAC at sea level

MATERIAL:

- Contact: Phosphor bronze, Gold flash plated
- Insulator: PBT UL94V-0
- Solder tails: Tin plated
- Shell: Tin plated over nickel underplate

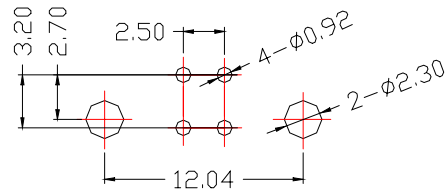
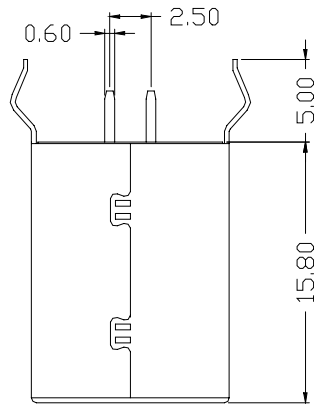

PCB BOARD LAYOUT

